



17 Southdown Road Elderslie, NSW

 3
  2
  2

Family Entertainer On 738m2

Be sure to inspect this impressive family home positioned on a superb 738m2 block of land in sought after Elderslie. Conveniently located to schools, parks, shopping precincts and much more. This property is a must on your inspection list.

The home boasts a versatile floor plan for relaxed everyday living and is perfect for indoor/outdoor entertaining. Boasting a large formal lounge plus a dining/meals area to suit the growing family.

All entertainers will thoroughly enjoy the spacious covered alfresco overlooking the landscaped gardens and stunning in-ground saltwater pool, a great place to relax and unwind.

This is the complete family package in a superb location, so close to the ever-popular Mawarra Primary School, walking distance to Elderslie High School and a lovely walk into Camden
Inspection will not disappoint.

- Impressive 3 bedroom home on level 738m2 block of land
- Master with ensuite, built-ins to 2 beds, ceiling fans to all
- Spacious kitchen, dishwasher, plenty of storage



Trevor Ive



Paul Vella

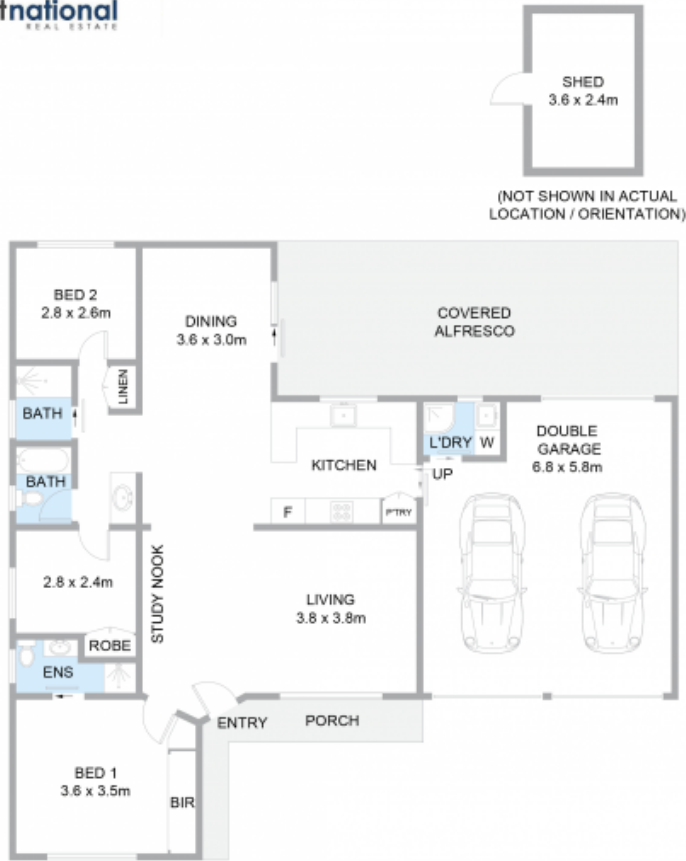

SITE PLAN
(NOT TO SCALE)

N →

Internal : 150.3 sqm
External : 40.1 sqm

17 Southdown Road, Elderslie

Scale in metres. Indicative only. All information contained herein is obtained from sources we believe to be accurate. We cannot guarantee its accuracy. Interested persons should make and rely on their own enquiries.