



229 Menangle Street Picton, NSW

 6  3  2

## Country Charmer with Separate Guest House on 784m2

You'll certainly be impressed by what's on offer here!

A large four bedroom country style home plus a detached two bedroom guest house is a rare offering to the market.

Built in 2000, the spacious four bedroom home is full of character and offers a versatile floor plan. Boasting large living areas including a formal lounge/dining and spacious family room off the well appointed kitchen, you will not be disappointed.

Just some of the impressive character features on display include a classic country veranda, high 9ft ceilings, wide skirting boards, solid timber walls, cedar windows & doors, heritage light switches plus multiple elegant chandeliers throughout the home.

The impressive as new guest house is detached from the main home and has its own driveway with off street parking. It offers two good sized bedrooms with wide doorways and a large bathroom with shower to suit wheel chair access plus open plan living off the kitchen.



**Trevor Ive**

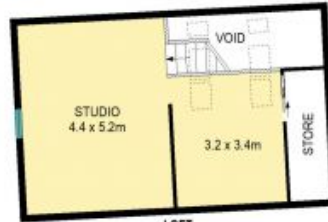

SITE PLAN (NOT TO SCALE)



0 1 2 3 4 5 6  
SCALE (METRES)

Scale in metres. Indicative only. Dimensions are approximate. All information contained herein is gathered from sources we believe to be reliable. However we cannot guarantee its accuracy and interested persons should rely on their own enquiries.

229 Menangle Street, Picton

**first national**  
REAL ESTATE | Gerard Smith

229 Menangle Street

Picton, NSW

**first national**  
REAL ESTATE | Gerard Smith