

20 Matthews Lane Picton, NSW

 6  3  5

## Durham Lodge on 11.91 acres

Durham Lodge was the name given to the homestead built on a unique and private 11.91 acre parcel of flat land a little over 50 years ago, just 700m from Picton railway station, and fronting Stonequarry Creek, part of the Upper Nepean catchment. The completion of the railway line in 1863 moved the quality sandstone quarried in the area, and brought Sydney sidlers to visit the area, including the mineral springs, on the southern boundary of the property, which gave the name to the road where the homestead is located.

Some of the original cedars remain of the many that were cleared to build the five bedroom, two story blonde brick residence in 1968, by Camden builder Leon Young, to the plans of Mrs FJ Durham, the original owner.

The homestead itself is set back from the private no through road, one street back from the main road, with a large driveway and turning circle.

The building features cypress flooring throughout, oversize bedrooms, high ceilings, double hung timber framed windows and numerous living areas designed to make the most of the views. There are two bathrooms upstairs, and two toilets downstairs. The gang-nailed hardwood roof trusses, formed by rolling through presses, were cutting edge technology



**Gerard Smith**



PARTIAL SITE PLAN (NOT TO SCALE)

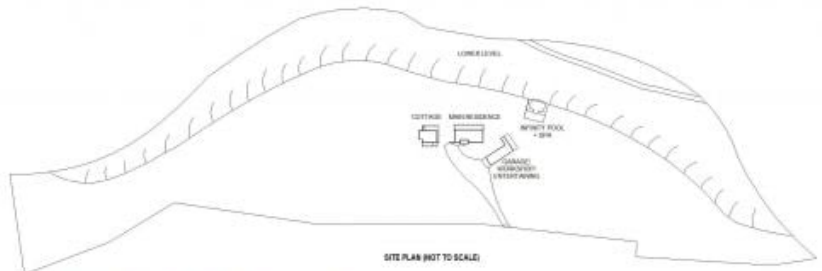

SITE PLAN (NOT TO SCALE)



MAIN RESIDENCE UPPER LEVEL



COTTAGE



MAIN RESIDENCE LOWER LEVEL

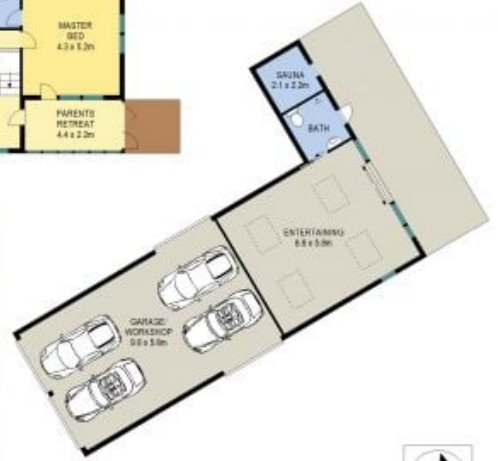

Scale in metres. Indicative only. Dimensions are approximate. All information contained herein is gathered from sources we believe to be reliable. However we cannot guarantee its accuracy and interested persons should rely on their own enquiries.

20 Matthews Lane, Picton



20 Matthews Lane

Picton, NSW

