



38-40 Picton Avenue Picton, NSW

 3  2  2

Historic Petherton on 2934m2

We are extremely proud to present this enchanting late Victorian Cottage C.1897. Perfectly positioned on a huge 2934m2 on 2 separate titles (2 x 1467m2).

This is your chance to secure a piece of Picton history. The fine example of late Victorian architecture is solidly constructed with double brick and local sandstone foundations and is in impeccable condition. Offering outstanding views and a lifestyle to match, all located within walking distance to Picton town centre.

The beautifully crafted historic home comprises gorgeous period features including original fireplaces, polished timber floorboards, 12' Baltic pine ceilings & French doors leading to the wraparound bull-nose verandah and leadlight windows. The many classic period features combine the ambiance of a bygone era with contemporary living including new ducted air conditioning & modern kitchen appliances and two new stylish bathrooms.

This impressive property occupies a prime corner position on 2 titles and it would be well worth consulting council in regards to the added potential this holds,



Trevor Ive

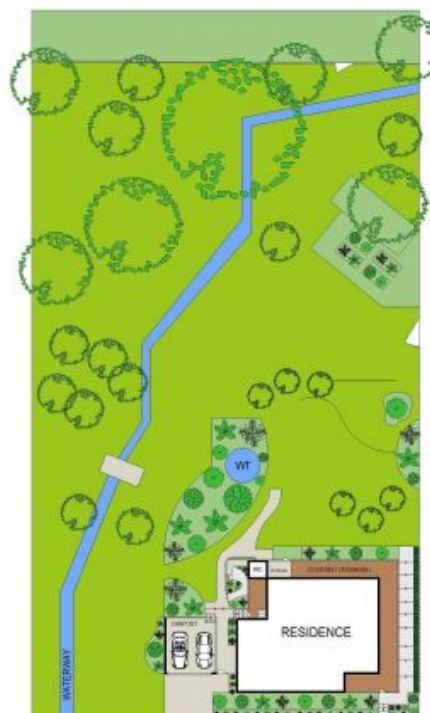

Scale in metres. Indicative only. Dimensions are approximate. All information contained herein is gathered from sources we believe to be reliable. However we cannot guarantee its accuracy and interested persons should rely on their own enquiries.

40 Picton Avenue, Picton

first national REAL ESTATE | Gerard Smith

38-40 Picton Avenue

Picton, NSW

first national REAL ESTATE | Gerard Smith