



290 Mulhollands Road Thirlmere, NSW

 6  3  4

## Two Homes on 11.56 Acres!

This is a unique opportunity ideally suited for two families looking to make the move onto quality acreage. Located in a sought after area and approx. 5 minutes to Picton and Thirlmere village this is a very rare find in todays market.

This impressive property has been built to accommodate dual living with both homes separately metered and offering 3 bedrooms each. The spacious main home has undergone a renovation to the kitchen, ensuite and bathroom in recent years and offers two large living areas. The attached second home has benefited from an update to the kitchen and has open plan living in a picture perfect rural setting.

If you are looking for privacy and space you will not be disappointed by what is on offer here. The acreage has been pasture improved with 6 fenced and gated paddocks and the property benefits from a water bore and large dam. This property is perfect for those looking for hobby farm pursuits and is a great opportunity to enjoy the beautiful lifestyle on offer.

Perfect dual living opportunity, 6 bedrooms on 11.56 acres.



**Trevor Ive**

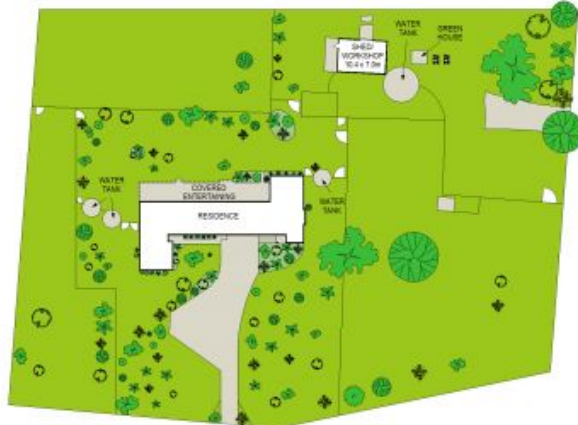

PARTIAL SITE PLAN (NOT TO SCALE)

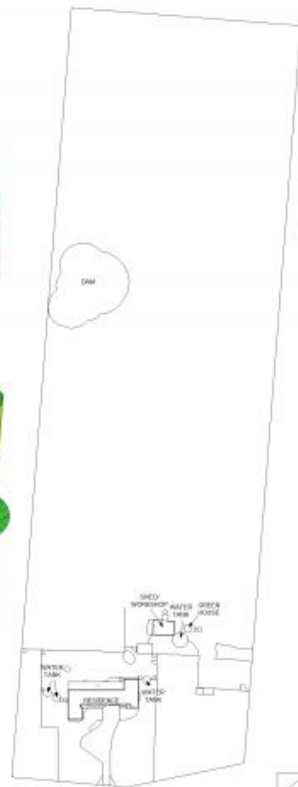

SITE PLAN (NOT TO SCALE)



Scale in metres, indicative only. Dimensions are approximate. All information contained herein is gathered from sources we believe to be reliable. However we cannot guarantee its accuracy and interested persons should rely on their own enquiries.

290 Mulhollands Road, Thirlmere



first  
national  
REAL ESTATE

Gerard Smith

290 Mulhollands Road

Thirlmere, NSW



first  
national  
REAL ESTATE

Gerard Smith