



12 Myers Way Wilton, NSW



4



2



2

## Family Stunner - Bingara Gorge

Welcome to Bingara Gorge! An exclusive estate where you can perfectly connect with the rural surrounds. With its beautiful tree-lined streets, spectacular backdrop of the Razorback Ranges, modern country feel, everything you need is at your doorstep.

This home is situated in a prime position and is only a 2 minute walk to the play ground for children to play. The living areas are extensive throughout; the home is ideally suited to the larger family.

- Superb 4 bedroom family home on 514m2
- Large gourmet kitchen with gas cooking + dish washer
- Master bedroom with walk in robe and ensuite
- Alfresco blends with the living allowing great space for entertaining
- Wide formal entry, ducted air-conditioning and downlights throughout
- Fully landscaped garden with fire pit
- Back to base alarm system
- Double remote garage with internal access

An appealing lifestyle on offer, with the home surrounded by quality homes in a prestige estate, which



**Gerard Smith**



**Trevor Ive**

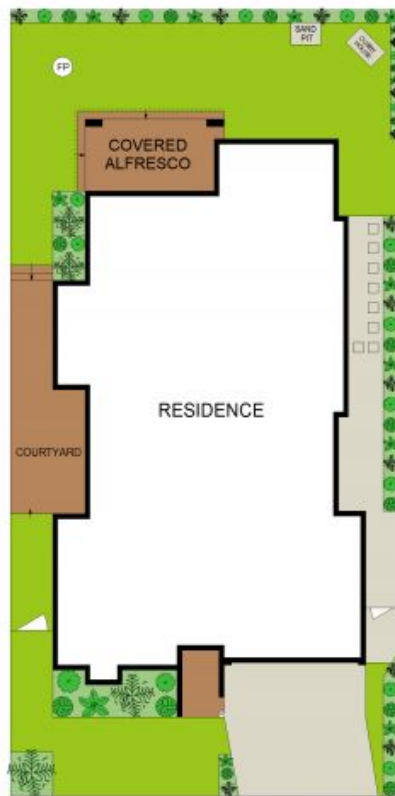

SITE PLAN (NOT TO SCALE)

0 1 2 3 4 5  
SCALE (METRES)

Scale in metres. Indicative only. Dimensions are approximate. All information contained herein is gathered from sources we believe to be reliable. However we cannot guarantee its accuracy and interested persons should rely on their own enquiries.



12 Myers Way, Wilton

**first national**  
REAL ESTATE | Gerard Smith

12 Myers Way

Wilton, NSW

**first national**  
REAL ESTATE | Gerard Smith