



6A Ella Street Hill Top, NSW

 4  2  2

Family Residence on 1000m2

BE QUICK TO SECURE THIS QUALITY HOME!!

Impressive and almost brand new this 4 bedroom home is ready for you to move into. Deluxe fittings and fixtures with an open feel yet private and serene. Perfect for large families or investors this home presents open-plan living, kitchen & dining areas, spacious bedrooms, a separate media room and an outside entertainment area/alfresco.

Bright and breezy with plenty of natural light, you'll feel just at home. Tiled throughout all living areas and carpet to all bedrooms this home offers low maintenance and a clean surrounding. Private battle axe entry allows extra privacy situated off the main road.

- Immaculate 4 bedroom home on 1000m2 walk-in and ensuite to main
- Spacious kitchen with stainless steel appliances
- Open plan living/dining
- Huge main bedroom with walk in robe and ensuite
- Large alfresco area + backyard perfect for the kids and/or guest entertainment
- Separate media room, 3 with built-ins



Gerard Smith

17/01/2012	17/01/2012
REVISION	DESCRIPTION
01	ISSUED FOR PERMIT
02	REVISED PERMIT
03	REVISED PERMIT
04	REVISED PERMIT
05	REVISED PERMIT
06	REVISED PERMIT
07	REVISED PERMIT
08	REVISED PERMIT
09	REVISED PERMIT
10	REVISED PERMIT
11	REVISED PERMIT
12	REVISED PERMIT
13	REVISED PERMIT
14	REVISED PERMIT
15	REVISED PERMIT
16	REVISED PERMIT
17	REVISED PERMIT
18	REVISED PERMIT
19	REVISED PERMIT
20	REVISED PERMIT
21	REVISED PERMIT
22	REVISED PERMIT
23	REVISED PERMIT
24	REVISED PERMIT
25	REVISED PERMIT
26	REVISED PERMIT
27	REVISED PERMIT
28	REVISED PERMIT
29	REVISED PERMIT
30	REVISED PERMIT
31	REVISED PERMIT
32	REVISED PERMIT
33	REVISED PERMIT
34	REVISED PERMIT
35	REVISED PERMIT
36	REVISED PERMIT
37	REVISED PERMIT
38	REVISED PERMIT
39	REVISED PERMIT
40	REVISED PERMIT
41	REVISED PERMIT
42	REVISED PERMIT
43	REVISED PERMIT
44	REVISED PERMIT
45	REVISED PERMIT
46	REVISED PERMIT
47	REVISED PERMIT
48	REVISED PERMIT
49	REVISED PERMIT
50	REVISED PERMIT

WARNING: CHANGING OR FOLDING WILL LEAD TO REJECTION

Sheet 1 of 1 (Sheet)

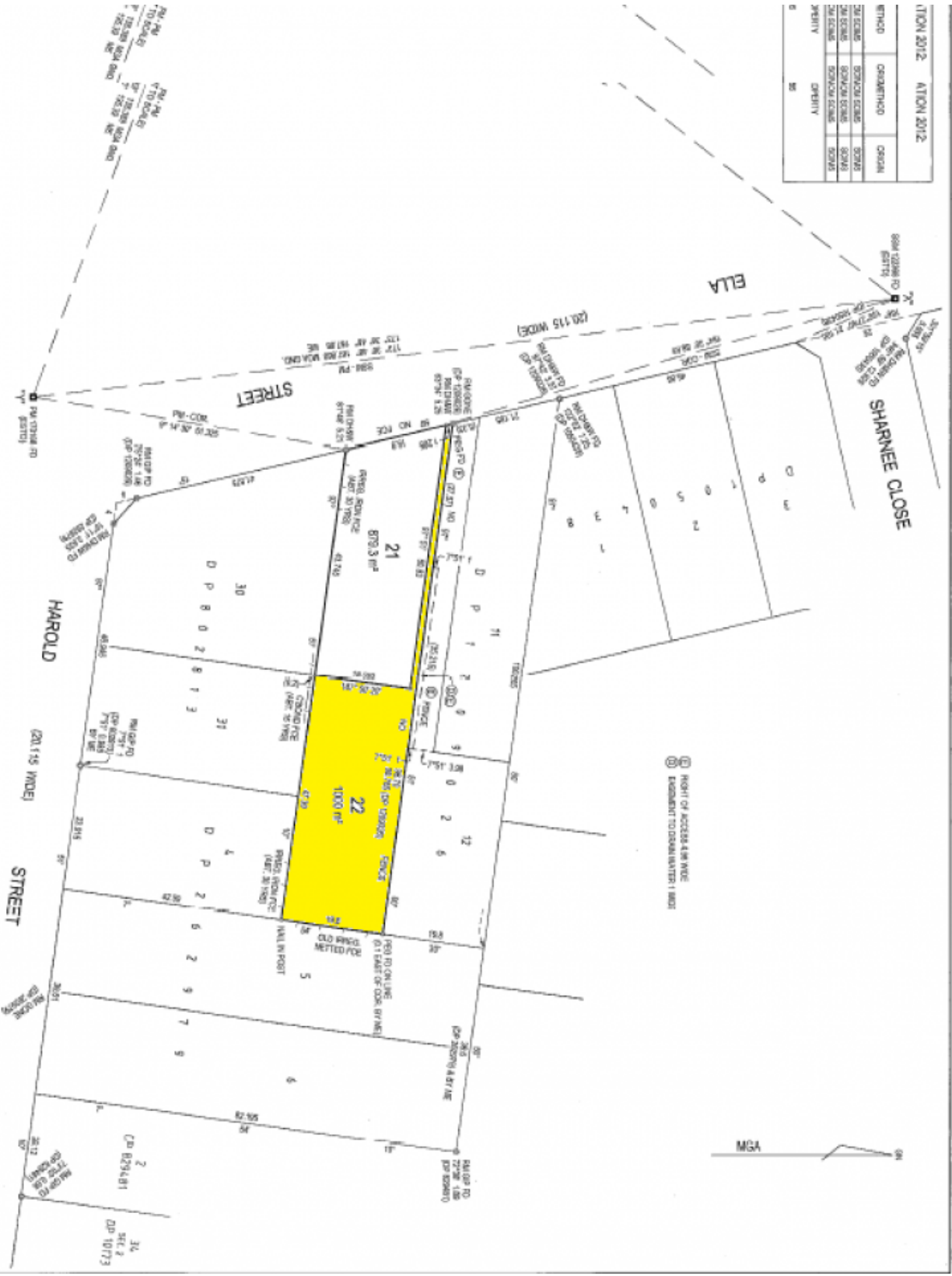

Surveyor: RICHARD R. COX
 Date of Survey: 17/03/2016
 Survey Reference: 15198

PLAN OF SUBDIVISION OF
 LOT 2 DP 282979 AND EASEMENTS
 OVER LOT 12 DP 1209026

L.G.A.: WINGECARRIBEE
 Locality: HILL TOP
 Subdivision No.: 150067/04
 Landmarks in terms: Redwood Road 1:500

Registered
 16.09.2016

DP1224168 P